

## Description



Operating your battery bank without good metering is like running your car without any gauges, although possible to do, it's always better to know how much fuel is left in the tank. Defining the amount of energy available in a battery is a complex task since battery age, discharge current and many other factors influence the actual battery capacity. The e-xpert lite uses the same very accurate measurement and calculation systems as the high-end e-xpert pro.

The e-xpert lite selectively displays voltage, charge- and discharge current, consumed amphotours and remaining battery capacity. Using a clear backlit LCD and an intuitive user interface, all parameters can be recalled with just a button press. A second battery input is also provided to monitor an auxiliary battery. A large bargraph delivers instant state of charge information.

Compared to the e-xpert pro, the e-xpert lite is a more basic instrument, perfectly suited for users focused on accurate state of charge readout and very easy setup.

## Features

- ▶ Read your battery bank like a fuel gauge
- ▶ Provides critical information about the status of your battery bank
- ▶ Displays voltage, current, consumed amphotours and remaining battery capacity
- ▶ Two battery inputs
- ▶ Large backlit LC Display
- ▶ Autosensing battery voltage inputs
- ▶ Quick nut mounting construction ▶ Programmable alarm relay
- ▶ Shunt selection capability enables flexible system integration
- ▶ Splash proof frontpanel
- ▶ 500 Amp shunt included
- ▶ CE and e-mark certified
- ▶ 24 month warranty

## Applications

- ▶ Recreational vehicles
- ▶ Solar power systems
- ▶ Industrial systems
- ▶ Forklifts
- ▶ Mobile entertainment systems
- ▶ Service vehicles
- ▶ Marine applications
- ▶ Remote homes

## Accessories

- ▶ Professional connection kit
- ▶ Quick connection kit

## Technical specifications

| Parameter                               | AlphaLINE e-xpert <i>lite</i>  |
|---|--|
| Supply voltage range                    | 9..35VDC   |
| Supply current <sup>1)</sup> :          | 7mA  |
| @Vin=24VDC                              | 9mA  |
| @Vin=12VDC                              |  |
| Input voltage range (auxiliary battery) | 2..35VDC   |
| Input voltage range (main battery)      | 0..35VDC   |
| Input current range <sup>2)</sup>       | -999..+999A  |
| Battery capacity range                  | 20..999Ah  |
| Operating temperature range             | -20..+50 °C  |
| Readout resolution :                    |  |
| voltage (0..35V)                        | ± 0.1V   |
| current (0..100A)                       | ± 0.1A   |
| current (100..999A)                     | ± 1A   |
| amphours (0..100Ah)                     | ± 0.1Ah  |
| amphours (100..999Ah)                   | ± 1Ah  |
| state-of-charge (0..100%)               | ± 0.1%   |
| Voltage measurement accuracy            | ± 0.3%   |
| Current measurement accuracy            | ± 0.4%   |
| Dimensions :                            |  |
| frontpanel                              | ∅ 64mm   |
| body diameter                           | ∅ 52mm   |
| total depth                             | 79mm   |
| weight                                  | 95gr   |
| Shunt dimensions :                      |  |
| footprint                               | 45 x 87mm  |
| height                                  | 17mm (base) / 35mm (high current screws)   |
| weight                                  | 145gr  |
| Protection class                        | IP20 (frontpanel only IP65)  |
| Complies with the following standards   | EN61000-6-3 (EN55022), EN61000-6-2 (EN61000-2/3/4, EN61000-4-3), LVD 73/23/EEC (EN60335-1), e4-95/54/EC, RoHS 2002/95/EC |

*Note: the given specifications are subject to change without notice.*

1) Measured with backlight and alarm relay turned off.

2) Depends on selected shunt. With standard delivered 500A/50mV shunt (350A continuous), the range is limited to -600..+600A.

## Dimensions

Sideview :

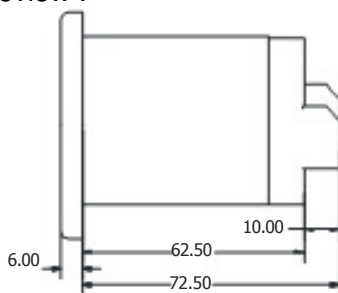

Frontview :



Rearview :

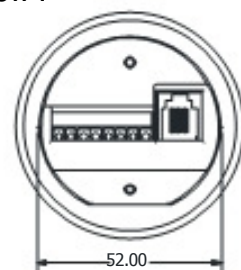

Mounting sequence :

